

Ref: []

SP-HLT-01

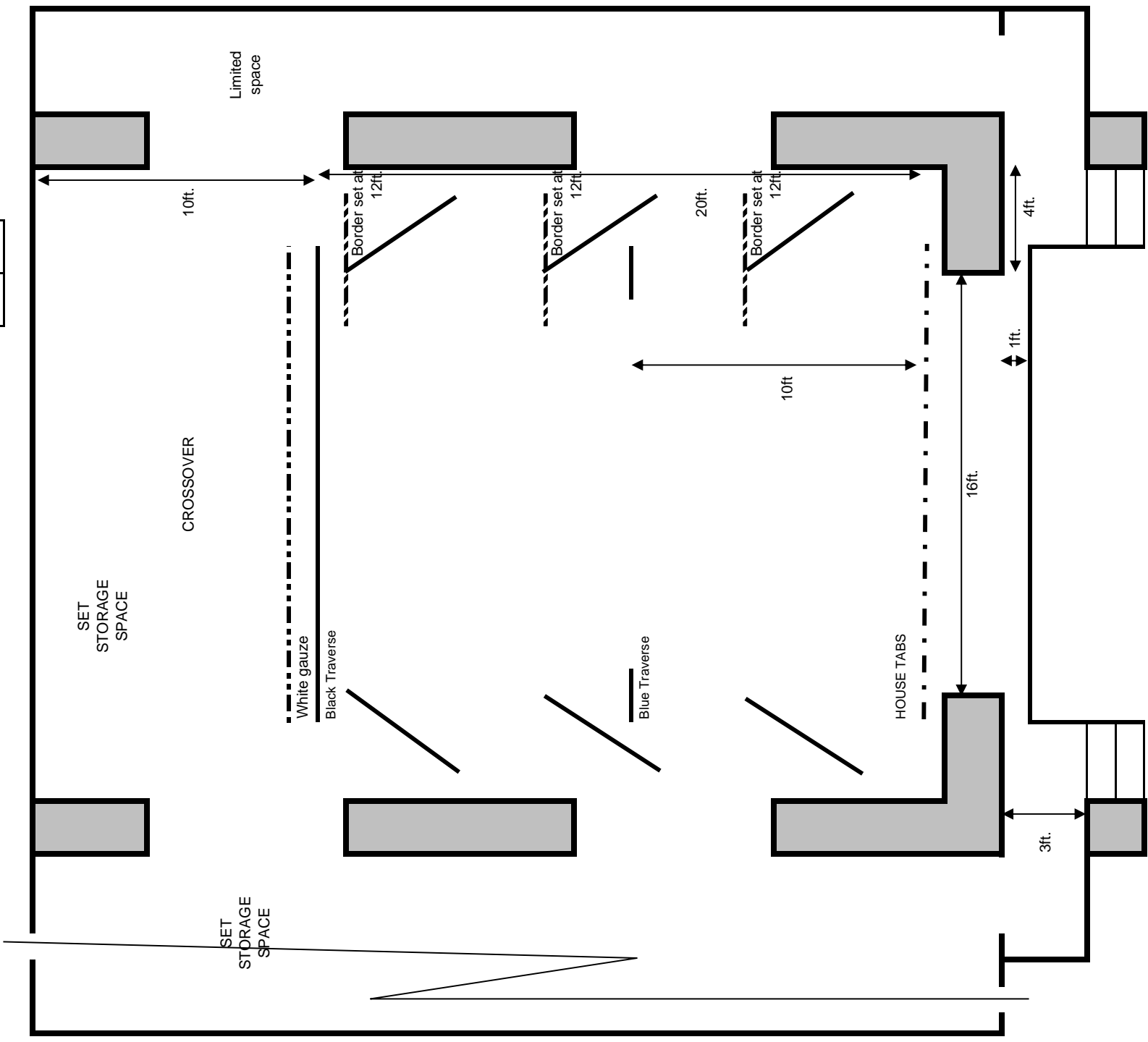

Aud. Entrance.

AUDITORIUM

Aud. Em. Exit.

NOTES

- 1 - Set access to the stage is direct from the outside. Stage Lt into private drive.
- 2 - There is **LIMITED** flying facilities. No Fly Tower.
- 3 - The masking either side of stage is by solid flats.
- 4 - The forestage is considered as unit.

NOT TO SCALE